

Do not scale from this drawing for construction or acquisition purposes. Responsibility is not accepted for errors made by others in scaling from this drawing. All construction information must be taken from figured dimensions only. All dimensions and levels must be checked on site and any discrepancies between drawings and specification must be reported to GSSArchitecture. © Copyright GSSArchitecture

Ordnance Survey © Crown Copyright 2018. All rights reserved. Licence number GSS 100017356.

Map Data Copyright 2018 Google.

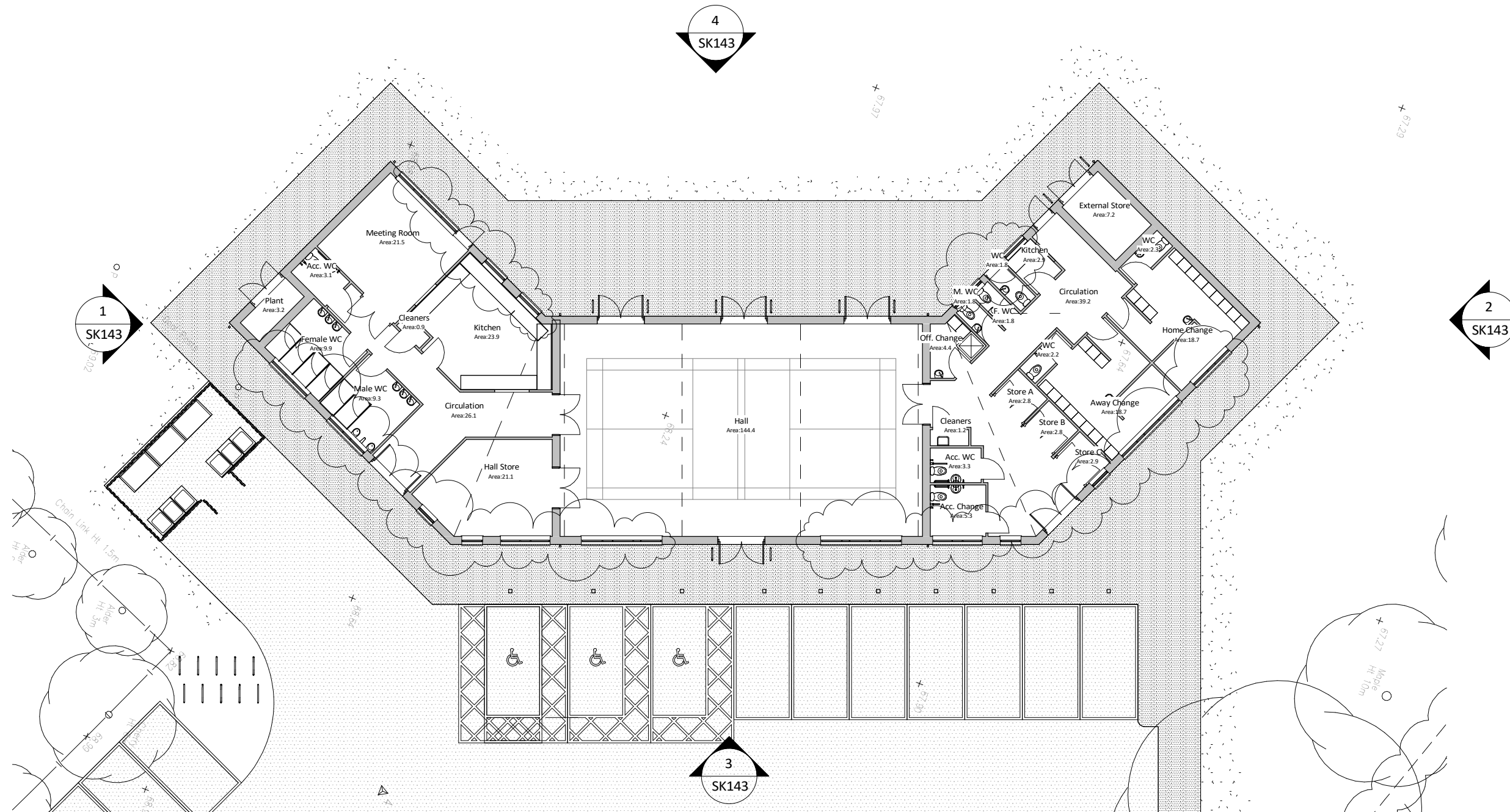

Rev.	Date	Drawn	Checked	Description
C	18/01/18	PB	WFA	Triangular windows omitted and replaced with rectangle. Recessed brickwork detail added to Main Sport Hall.
B	17/11/17	JPW	WFA	Windows to East Elevation, Main Hall, changed
A	09/11/17	JPW	WFA	Car Park Layout changed

**GSSarchitecture**

35 HEADLANDS, KETTERING,  
NORTHANTS, NN15 7ES  
Telephone: 01536 513 165. Email: gss@gotch.co.uk,  
Web: www.gssarchitecture.com

Gloucester: 01452 525 019, Harrogate: 01423 815 121,  
Milton Keynes: 01908 255 620, Newcastle: 01913 898 917



This drawing is purely for discussion purposes only. It is not to be taken as a proposal for construction detailing, and instead it is primarily intended to convey the overall spatial layout of the building or parts of it. Please refer to the developed production information drawings for detail, construction and measurement purposes.

**PRELIMINARY ISSUE**

**Project Title:**  
NEW VILLAGE HALL

**Client:**  
Cottingham and Middleton Village Hall Trust

**Drawing Title:**  
Proposed GF Plan - Village Hall

**File Number:** C127d  
**Drawn By:** JPW  
**Checked By:** WFA  
**Scale@A3:** 1 : 200 **Date:** 15.09.17  
**Dwg No:** SK142 **Rev:** C

**1. PROPOSED GF PLAN**  
**SCALE - 1 : 200@A3**